

**A1**

## FIRST FLOOR ELECTRICAL DEMOLITION PLANS

SCALE  $1/8" = 1'-0"$

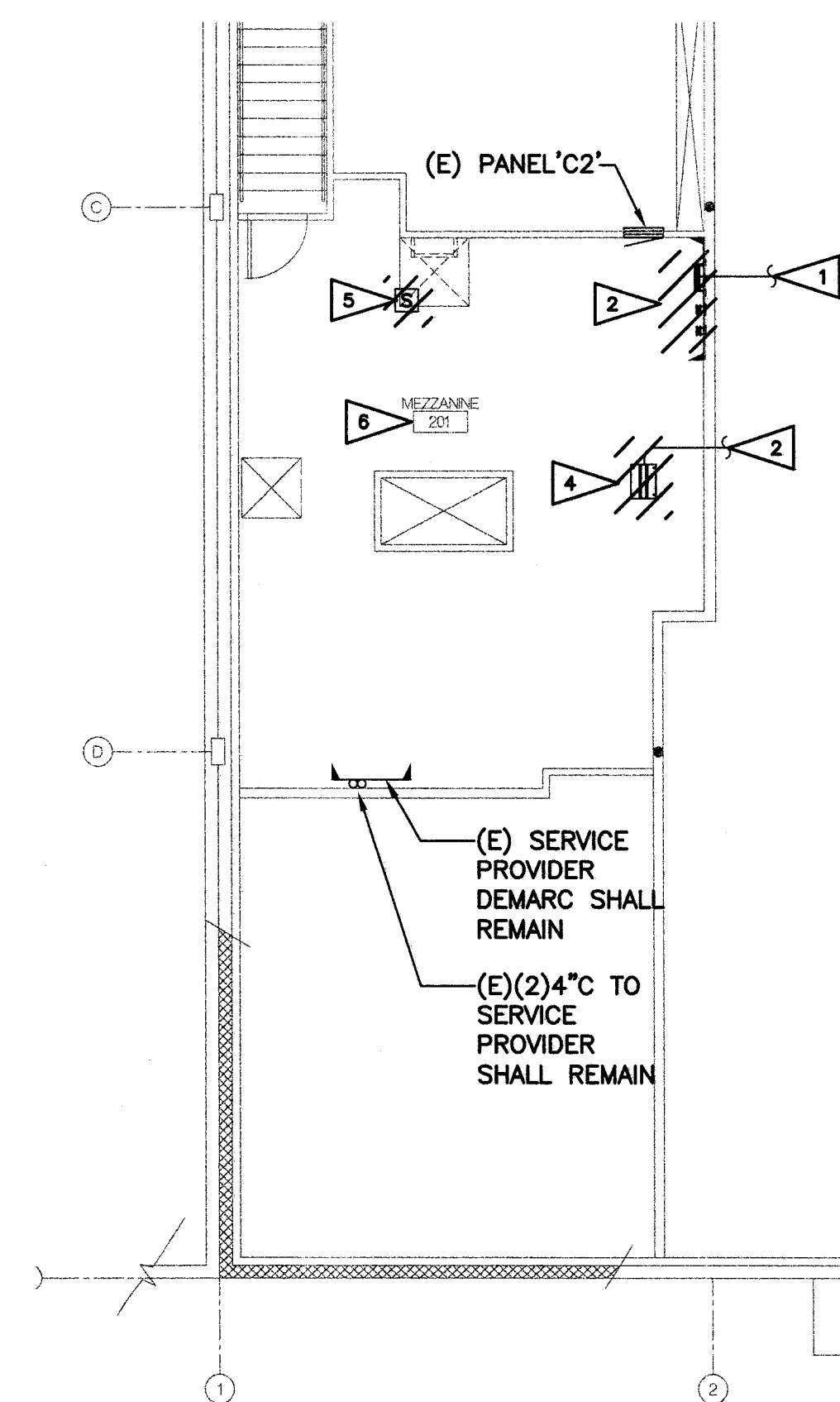

A8

## MEZZANINE ELECTRICAL DEMOLITION PLANS

SCALE: 1/8" = 1'-0"

**SHEET NOTES:**

1. DEMOLISH ALL EXISTING VOICE, DATA AND SECURITY CABLING LOCATED THROUGHOUT THE FACILITY IN ITS ENTIRETY.
2. ALL DEMOLISHED EQUIPMENT AND CABLING SHALL BE DISPOSED OF OFF SITE BY THE CONTRACTOR.
3. DEMOLISH ALL INTERIOR AND EXTERIOR EQUIPMENT/DEVICES IN THE SHADED AREA UNLESS OTHERWISE NOTED.

**FLAG NOTES:**

- 1 DEMOLISH (E) CABLING IN ITS ENTIRETY, APPROX. 120 CABLES THROUGHOUT THE FACILITY.
- 2 DEMOLISH (E) CABLING IN ITS ENTIRETY, APPROX. 60 CABLES THROUGHOUT THE FACILITY.
- 3 DEMOLISH (E) WALL MOUNT EQUIPMENT.
- 4 DEMOLISH (E) 5'-0" 2-POST RACK AND PATCH PANELS.
- 5 DEMOLISH (E) MAGNETIC DOOR CONTACT ON ROOF HATCH
- 6 EXISTING LIGHTING AND POWER DEVICES IN THIS ROOM SHALL REMAIN. DEMOLISH AND REPLACE EXISTING WIRING AS REQUIRED TO MAINTAIN CONDUCTOR COLOR TO ACCOMMODATE NEW CIRCUITING AS INDICATED ON SHEET E2.01 AND E3.01.
- 7 EXISTING SOFFIT LIGHTING SHALL REMAIN.
- 8 SAWCUT AND TRENCH EXISTING SLAB TO ACCOMMODATE NEW ELECTRICAL CONDUIT PATHWAYS TO FLOOR BOXES. SEE SHEET E3.02 AND E6.02 FOR ADDITIONAL INFORMATION.
- 9 EXISTING SURFACE MOUNTED LIGHTING FIXTURES IN THIS ROOM SHALL REMAIN. EXISTING LIGHT FIXTURE ROUGH-IN AND RESPECTIVE LIGHT SWITCH ROUGH-IN AND WIRING IN THIS ROOM SHALL REMAIN. DEMOLISH AND REPLACE EXISTING WIRING AS REQUIRED TO MAINTAIN CONDUCTOR COLOR TO ACCOMMODATE NEW CIRCUITING AS INDICATED ON SHEET E2.01.
- 10 EXISTING ELECTRICAL EQUIPMENT AND RECEPTACLES IN THIS ROOM SHALL REMAIN. DEMOLISH EXISTING LIGHTING FIXTURE AND ASSOCIATED WIRING. EXISTING IRRIGATION CONTROLLER SHALL REMAIN. EXISTING CONTROL RACEWAY AND CONDUCTORS FROM CONTROLLER TO EXTERIOR IRRIGATION DEVICES SHALL BE MAINTAINED. SEE DETAIL A2, SHEET E7.01 FOR ADDITIONAL INFORMATION.



/10/2013

DESIGN WEST

**A R C H I T E C T S, P. A.**  
7513 W KENNEWICK AVE SUITE D  
KENNEWICK, WA 99336  
PH. (509) 783-2244 FAX (509) 783-8776

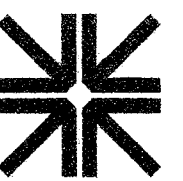

# CHARGES

**Hargis Engineers, Inc.**  
300 Stewart Street, Suite 1000 | Seattle, WA 98101  
t | 206.448.3376 f | 206.448.4450 w | hargis.biz

ENGINEERS | MECHANICAL - ELECTRICAL - TELECOMMUNICATIONS

**KENNEWICK SCHOOL DISTRICT**  
**1315 BUILDING RENOVATIONS**  
**1315 WEST 4TH AVENUE**

**KENNEWICK, WA.  
99336**

## REVISIONS

RAWN BY:  
JPH, DB

HECKED BY:  
MLR

DATE  
12/19/2012

OB NUMBER  
1278

SHEET NAME

## FIRST FLOOR AND MEZZANINE ELECTRICAL DEMOLITION PLANS

SHEET

## ED1.01